

DB - BELT DRIVE CENTRIFUGAL ROOF EXHAUSTER

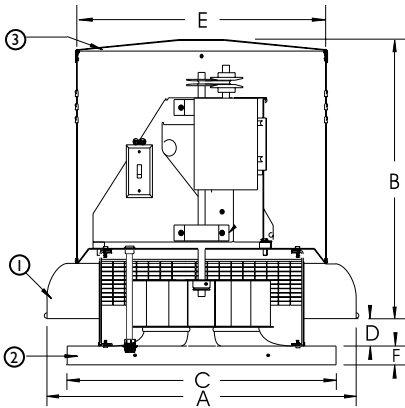

JencoFan, Div. of Soler & Palau Ventilation Group certifies that the Models DB shown herein are licensed to bear the AMCA Seal. The ratings shown are based on test and procedures performed in accordance with AMCA Publication 211 and AMCA Publication 311 and comply with the requirement of the AMCA Certified Ratings Program.



STANDARD CONSTRUCTION FEATURES

- All aluminum exterior construction.
- Stainless steel exterior fasteners.
- Ventilated motor compartment.
- Prepunched curb cap with welded corners.
- Aluminum nonoverloading wheel.
- Adjustable v-belt drive.
- Motor & drive factory mounted (**except 184T and larger**).
- Mounted service disconnect (except 2 speed and XP motors).
- Pillow block ball bearings (L50 = 200k with lube fittings).
- Internal wiring chase.
- Aluminum birdscreen and windband.
- Neoprene vibration isolators.
- AMCA Certified Air and Sound.

SUBMITTAL DRAWING

SIZE	DIMENSIONS (IN.)								Damper OD	MIN. METAL THICKNESS (ALUM.)			AVG. SHIP WT. LBS.		
	A	B	C	D	E	F	G	H		SKIRT ①	CURB CAP ②	LID COVER ③			
6-8-9	20 1/2	17 1/2	16 1/2	3 1/2	16 1/8	1 3/4	15	12	11	.063	.050	.050	65		
11	28 3/8	23	24	3	22 1/2	2	22 1/2	19 1/2	18		.080		.080	105	
12	28 3/8	23	24	3 1/4	22 1/2	2	22 1/2	19 1/2	18					.090	.090
14	28 3/8	23	24	3 1/4	22 1/2	2	22 1/2	19 1/2	18	.090					
16	32 1/4	23 3/4	24	5 3/4	26 1/4	2 1/2	22 1/2	19 1/2	18					.090	.090
18	32 1/4	24	29 1/2	4 1/2	26 1/4	2 1/2	28	24 3/4	24	.090	.090		160		
20	36 3/4	24 1/2	29 1/2	4	26 1/4	2 1/2	28	24 3/4	24				.090	.090	215
24	41 1/4	26 1/2	35 3/4	8	30	2	34	30 3/4	30	.090	.090	270			

A - Skirt OD (Dia). E - Motor cover OD (Dia).
 B - Height. F - Curb cap flange.
 C - Curb cap OD. G - Recommended roof curb OD (allows 3/4" for flashing).
 D - Skirt height. H - Recommended roof opening.

DIMENSIONS REPRESENT GENERAL CONSTRUCTION AND MAY VARY SLIGHTLY. CONTACT FACTORY FOR CERTIFIED DRAWINGS.

FAN SPECIFICATIONS									MOTOR SPECIFICATIONS				
Line	Qty.	Model No.	Tag	CFM	SP	Fan RPM	BHP	Sones	HP	Volts	Phase	Hertz	Encl
1													
2													
3													
4													
5													

ACCESSORY ITEMS	1	2	3	4	5	ACCESSORY ITEMS	1	2	3	4	5
<input type="checkbox"/>						<input type="checkbox"/>					
<input type="checkbox"/>						<input type="checkbox"/>					
<input type="checkbox"/>						<input type="checkbox"/>					
<input type="checkbox"/>						<input type="checkbox"/>					
<input type="checkbox"/>						<input type="checkbox"/>					